

C:\BIBERS\STAVELUP\ORNDORF\STUDIOS\BECOMANY DOCUMENTS\JESSAMINE DESIGN\PROJECTS\URBAN\ACT 1 IN FEDERAL HIGHWAY\CAULS LANDSCAPE PLANNING\DESIGN BY STEVE

POMPANO BEACH LANDSCAPE CODE COMPLIANCE CHART		
TOTAL AREA: 118,416 SF ZONING: B-3 (GENERAL BUSINESS)		
	REQUIRED	PROVIDED
155.5203.B.2.g.ii - HEIGHT AT LEAST 50% OF THE REQUIRED CANOPY TREES SHALL BE 16' HT AND PALMS 22 IF THE PRINCIPAL STRUCTURE IS BETWEEN MORE THAN 25' (PRINCIPAL STRUCTURE: 90') 113 TREES/PALMS REQUIRED x 50% = 57 TREES/PALMS	57 TREES/PALMS	96 TREES/PALMS (BS, QV, TH, TD,RR, SP)
155.5203.C - MINIMUM DEVELOPMENT SITE LANDSCAPING ONE TREE AND 5 SHRUBS PER 3,000 SF OF LOT AREA OR MAJOR FRACTION THEREOF 118,416 SF / 3,000 = 40 TREES + 200 SHRUBS	40 TREES + 200 SHRUBS	66 TREES/PALMS + 2,103 SHRUBS
155.5203.D.3.b - VUA PERIMETER LANDSCAPE STRIPS PERIMETER LANDSCAPE STRIPS SHALL BE COMPRISED OF THE FOLLOWING: NORTH: 372 / 30' = 13 TREES UNDERSTORY TREES CONTINUOUS HEDGE 10' WIDE PER 155.5203.D.3.d, VUA PERIMETER STRIP LANDSCAPE MAY BE CREDITED TOWARDS PERIMETER BUFFER STANDARDS	13 TREES HEDGE 10' WIDE	13 TREES (LJ) 4' HEDGE 10' WIDE
155.5203.D.4 - INTERIOR LANDSCAPE STANDARDS EACH LANDSCAPED ISLAND SHALL BE BE AT LEAST EIGHT WIDE AND AT LEAST AS LONG AS THE ADJACENT PARKING SPACES AND CONTAIN ONE CANOPY TREE. 4 ISLANDS x 1 TREE = 4 TREES	4 TREES	4 TREES
155.5203.D.5 - LANDSCAPING BETWEEN VUA AND BUILDINGS THE MIN. WIDTH OF THE LANDSCAPED AREA SHALL BE EIGHT FEET FOR EACH 15' OF HEIGHT FOR THE ABUTTING BUILDING FACADE WITH AN ADDITIONAL 1' FOR EACH ADDITIONAL 2' OF BUILDING HEIGHT (UP TO 24'). 90' BUILDING HEIGHT = 24' PLANTING AREA	24' PLANTING AREA (2,967 SF)	12.4' - 20.4' (1,909 SF) + SUPERIOR LANDSCAPING (SEE EXHIBIT BELOW)
155.5203.E.3 - BUILDING BASE PLANTINGS SHRUBS SHALL BE PLANTED ALONG THE BASE OF ANY BUILDING FACADE FACING A STREET. REQUIRED SHRUBS SHALL BE PLANTED WITHIN 3' OF THE BASE OF THE BUILDING AND UP TO 15' WHEN A SIDEWALK IS PROVIDED. PLANTINGS SHALL BE PROVIDED AT MAX 6' OC EAST: 52 LF / 6 = 9 SHRUBS	EAST: 9 SHRUBS	EAST: 59 SHRUBS (PN & LM)
155.5203.F - PERIMETER BUFFERS NORTH: TYPE A BUFFER (OPTION 1) MIN 10' WIDE 1 CANOPY TREE PER 30 LF + 4' HT HEDGE 537.5' / 30' = 18 TREES EAST: TYPE A BUFFER MIN 10' WIDE 1 CANOPY TREE PER 30 LF + 4' HT HEDGE 194.1' / 30' = 7 TREES (DOES NOT INCLUDE ROW. SEE STREET TREE SECTION) SOUTH (ADJACENT TO RM-12): TYPE C BUFFER (OPTION 1) MIN 10' WIDE 8'HT MASONRY WALL 1 UNDERSTORY TREE PER 30 LF EXTERIOR OF WALL 320.9' / 30' = 11 UNDERSTORY TREES 1 CANOPY TREE PER 30 LF INSIDE OF WALL 320.9' / 30' = 11 CANOPY TREES 5' HT HEDGE SOUTH (ADJACENT TO B-3): TYPE A BUFFER (OPTION 1) MIN 10' WIDE 1 CANOPY TREE PER 30 LF + 4' HT HEDGE 197.2' / 30' = 7 TREES WEST: TYPE A BUFFER (OPTION 1) MIN 10' WIDE 1 CANOPY TREE PER 30 LF + 4' HT HEDGE 330' / 30' = 11 TREES	NORTH 10' WIDE 18 TREES 4' HEDGE EAST 10' WIDE 7 TREES 4' HEDGE SOUTH (RM-12) 10' WIDE 8'HT WALL 11 US. TREES 11 CAN. TREES 5' HEDGE SOUTH (B-3) 10' WIDE 7 TREES 4' HEDGE WEST 10' WIDE 11 TREES 4' HEDGE	NORTH 10' WIDE 23 TREES 4' HEDGE EAST 10' WIDE 12 TREES 4' HEDGE SOUTH (RM-12) 10' WIDE 8'HT WALL 18 US. TREES 11 CANOPY TREES 5' HEDGE SOUTH (B-3) 15' WIDE 13 TREES 4' HEDGE WEST 10' WIDE 18 TREES 4' HEDGE
155.5203.G - STREET TREES ONE STREET TREE PER 40' OF STREET FRONTAGE SOUTH (FEDERAL HIGHWAY) 137.2 / 40' = 4 TREES	4 TREES	4 TREES (BS)
TOTAL TREES REQUIRED 40+13+2+18+7+18+11+4 = 113 TREES	113 TREES	198 TREES/PALMS*
155.5203.B.1.b - NATIVE VEGETATION AND DIVERSITY MIN. 50% OF REQUIRED TREES SHALL BE NATIVE 113 REQUIRED TREES/PALMS x 50% = 57 NATIVE TREES MAX. 20% PALMS AS REQUIRED TREES 113 REQUIRED TREES x 20% = MAX 22 PALMS MIN. 4 SPECIES FOR REQUIRED TREES = 4 SPECIES	57 NATIVE TREES MAX 22 PALMS 4 SPECIES	87 NATIVE TREES 0 PALMS** 10 SPECIES

* 85 ADDITIONAL TREES BEYOND DEVELOPMENT REQUIREMENTS ARE APPLIED TOWARD TREE MITIGATION. DETAILED CALCULATIONS ARE SHOWN ON SHEET L-1.
** PALMS ARE FOR MITIGATION ONLY AND NOT COUNTED TOWARDS TOTAL TREE QUANTITY REQUIREMENTS

PLANT SCHEDULE						
CODE	QTY	BOTANICAL NAME	COMMON NAME	CAL	CONT	SIZE
TREES						
(N) BS	4	Bursera simaruba	Gumbo Limbo	4" Cal	FG	16' HT x 6' SPR
(N) CS	30	Cordia sebestena	Orange Geiger Tree	2.5" Cal	FG	12' HT x 5' SPR
LJ	20	Ligustrum japonicum 5 Stems min. 4" Cal total.	Ligustrum	Multi	Cont	8' HT x 8' SPR
PU	2	Pandanus utilis Heavy. Specimen.	Screw Pine	N/A	FG	14' HT
(N) QV	12	Quercus virginiana	Southern Live Oak	4" Cal	Cont	16' HT x 5' SPR
TH	31	Tabebuia heterophylla	Pink Tabebuia	4" Cal	Cont	16' HT x 6' SPR
(N) TD	41	Taxodium distichum	Bald Cypress	4" Cal	Cont	16' HT x 5' SPR
PALM TREES						
AM	9	Adonidia merrillii Triple trunk. Matching trunk.	Christmas Palm	N/A	Cont	8' HT
BN	5	Bismarckia nobilis 6 good or excellent leaves.. Straight trunk. Slick.	Bismarck Palm	N/A	FG	12' GW
PR	6	Phoenix roebelenii Triple trunk. Matching	Pygmy Date Palm	N/A	Cont	8' HT
PS	3	Phoenix sylvestris 32 good or excellent leaves. Straight trunk. 18" cal. @ 4' above grade. Classic cut. Inoculated prior to arrival to site.	Sylvester Date Palm	N/A	FG	12' CT
(N) RR	12	Roystonea regia Min 22" OA. 6 good or excellent leaves. Heavy. Straight trunk. Min 18" Cal 4' above rootball.	Royal Palm	N/A	B&B	14' GW
(N) SP	23	Sabal palmetto Slick Trunk. Stagger heights in groupings.	Sabal Palm	N/A	FG	22' HT
CODE	QTY	BOTANICAL NAME	COMMON NAME	CONT	SIZE	SPACING
SHRUBS						
AW	59	Acalypha wilkesiana	Wilkes' Copperleaf	Cont	24x24	24" OC
(N) CR	440	Chrysobalanus icaco 'Red Tip'	Red Tip Coco Plum	Cont	48" HT	24" OC
(N) CG	203	Clusia guttifera	Small Leaf Clusia	Cont	48" HT	24" OC
(N) CE	99	Conocarpus erectus 'sericeus' Full to base	Silver Buttonwood	Cont	5' HT	36" OC
CA	35	Cordyline fruticosa 'Auntie Lou' Min. 5 matching stems.	Auntie Lou Ti Plant	Cont	4' HT	
LG	11	Licuala grandis	Licuala Palm	N/A	Cont	4' HT
(N) PN	61	Psychotria nervosa	Wild Coffee	Cont	24" HT	36" OC
RE	22	Rhapis excelsa	Lady Palm	Cont	36" HT	36" OC
SR	25	Strelitzia reginae	Bird Of Paradise	Cont	36" HT	As Shown
CODE	QTY	BOTANICAL NAME	COMMON NAME	CONT	SIZE	SPACING
SHRUB AREAS						
AH	21	Acalypha hispida	Chenille Plant	Cont.	24" HT	30" OC
FG	278	Ficus microcarpa 'Green Island'	Green Island Ficus	Cont.	12x12	18" OC
JC	109	Juniperus chinensis	Juniper	Cont.	24" SPR	24" OC
(N) MC	256	Muhlenbergia capillaris	Pink Muhly Grass	Cont.	24" HT	36" OC
PX	129	Philodendron x 'Xanadu'	Xanadu Philodendron	Cont.	24x24	30" OC
TC	78	Tabernaemontana divaricata	Pinwheel Jasmine	Cont.	24x24	30" OC
(N) TN	108	Tripsacum dactyloides nana	Dwarf Fakahatchee Grass	Cont.	24" HT	36" OC
(N) ZP	169	Zamia pumila	Coontie	Cont.	24x24	30" OC
GROUND COVERS						
AP	86	Acalypha pendula	Trailing Chenille	Cont.	12" SPR	12" OC
(N) HD	195	Helianthus debilis	Beach Sunflower	Cont.	10" HT	12" OC
(N) IV	148	Ilex vomitoria	Yaupon Holly	Cont.	10" HT	24" OC
LM	94	Liriope muscari 'Super Blue'	Super Blue Liriope	Cont.	10" HT	24" OC
SOD	±17,761 sf	Stenotaphrum secundatum 'Floratum'	Floratum St. Augustine Grass	SOD		
STONE	±1,214 sf	Stone Mulch 1-3" River Jack Stone @ 3" Thick with geotextile soil separator.		Stone		
(N) NATIVE						

- PLANTING NOTES**
1. PRIOR TO INSTALLATION OF PLANT MATERIAL, CONTRACTOR SHALL VERIFY THAT THE FINISHED GRADES IN ALL AREAS WHERE PLANT MATERIALS ARE TO BE INSTALLED CONFORMED TO THE PROPOSED GRADES NOTED ON THE GRADING PLAN.
 2. PLANT MATERIAL SHALL BE IRRIGATED BY AN AUTOMATIC UNDERGROUND IRRIGATION SYSTEM, WHICH SHALL BE INSTALLED AND OPERATIONAL PRIOR TO PLANTING. TREES MAY BE INSTALLED PRIOR TO THE INSTALLATION OF IRRIGATION, PROVIDED THAT A HAND WATERING SCHEDULE IS SUBMITTED AND APPROVED BY THE OWNERS REPRESENTATIVE.
 3. CONTRACTOR SHALL CONFIRM THAT ALL ORGANICS, SOD, WEEDS, ROOTS, AND DEBRIS SHALL BE REMOVED TO A DEPTH OF 12" FROM ALL AREAS WHERE PLANT MATERIAL IS TO BE INSTALLED.
 4. CONTRACTOR SHALL PAINT THE OUTLINE OF EACH SHRUBS BED AND STAKE THE LOCATION OF ALL TREES FOR APPROVAL BY THE OWNERS REPRESENTATIVE.
 5. REFER TO PLANTING DETAILS AND SPECIFICATIONS FOR ADDITIONAL INSTRUCTIONS.
 6. QUANTITIES SHOWN ON THE PLANTING SCHEDULE ARE FOR CONVENIENCE ONLY. SHOULD A CONFLICT EXISTING BETWEEN THE PLAN AND SCHEDULE, THE PLAN SHALL TAKE PRECEDENCE. CONTRACTOR SHALL BRING ANY CONFLICT TO THE ATTENTION OF THE OWNER AND LANDSCAPE ARCHITECT.
 7. SHOULD CONTRACTOR NOTICE AN ERROR ON THESE PLANS, THEY SHOULD IMMEDIATELY BRING IT TO THE ATTENTION OF THE OWNERS REPRESENTATIVE AND THE LANDSCAPE ARCHITECT.

CITY OF POMPANO BEACH NOTES

1. AS PER CITY ORDINANCES 50.02(A)(4) AND 100.35(E), LANDSCAPE MATERIALS OTHER THAN SOD ARE NOT ALLOWED WITHIN (5') FIVE FEET OF ANY PORTION OF CITY OWNED UTILITIES WITHIN THE PUBLIC STREET RIGHT-OF-WAY INCLUDING METERS, HYDRANTS, SERVICE LINES, ETC.
2. NO TREES , SHRUBBERY OR OBSTRUCTION SHALL BE PLACED WITHIN A 3' RADIUS OF A CITY OWNED SEWER LATERAL CLEANOUT, OR WATER AND/OR USER METER.
3. ALL HEDGES ABUTTING CITY RIGHTS OF WAY ARE MAINTAINED AT A HEIGHT NO GREATER THAN 24".
4. A PRE CONSTRUCTION MEETING WITH URBAN FORESTRY IS REQUIRED BEFORE ANY WORK IS PERFORMED ON SITE WHERE THERE IS TREE PROTECTION AND/OR PLANT MATERIAL IS INSTALLED ON SITE.
5. ALL ROAD ROCK, CONCRETE, ASPHALT, AND OTHER NON-NATURAL MATERIAL SHALL BE REMOVED FROM ALL PLANTING AREAS AND REPLACED WITH PLANTING SOIL PRIOR TO LANDSCAPE INSTALLATION.
6. TO THE BEST OF THE ARCHITECTS OR ENGINEERS KNOWLEDGE, THE PLANS AND SPECIFICATIONS COMPLY WITH THE APPLICABLE MINIMUM BUILDING CODES AND APPLICABLE FIRE SAFETY STANDARDS AS DETERMINED BY THE LOCAL AUTHORITY AND FLORIDA BUILDING CODE.
7. ALL TREE WORK SHALL REQUIRE PERMITTING BY A REGISTERED BROWARD COUNTY TREE TRIMMER.
8. PLANT SPACING SHALL SUPERSEDE PLANT QUANTITY TO FILL PLANTING BEDS.
9. ONE SUBBLER SHALL BE PROVIDED FOR ALL NEW AND RELOCATED TREES AND PALMS.
10. ALL PALMS SHALL BE MAINTAINED FREE OF DEAD OR DAMAGED FRONDS AND SHALL BE TRIMMED AT LEAST 4X A YEAR TO REDUCE THE RISK OF HAZARDOUS FRONDS FALLING ONTO SIDEWALKS OR STREETS.

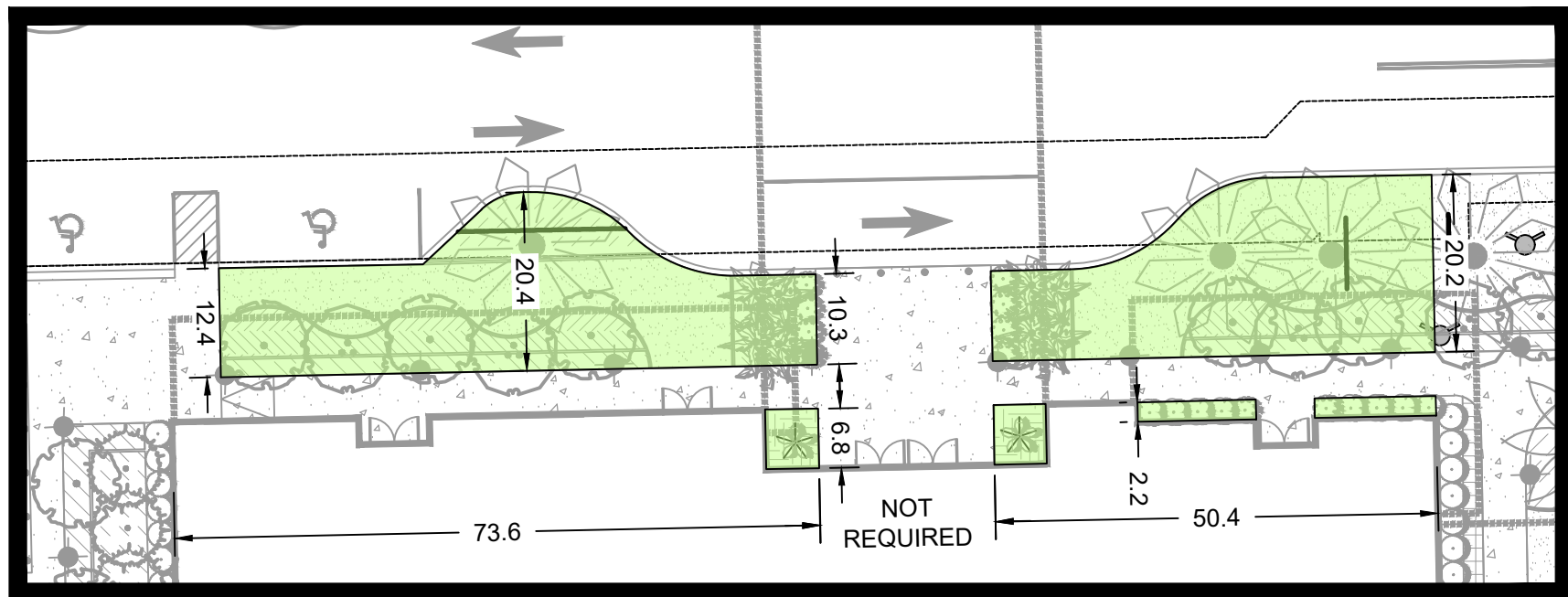

VEHICULAR USE AREA LANDSCAPE ENLARGEMENT

155.5203.D.5 - LANDSCAPE AREA BETWEEN VUA AND BUILDING

REQUIRED: 24' FOR 90' TALL PRIMARY STRUCTURE
124' x 24' = 2,976 SF

PROVIDED: 12.4 MIN. - 20.4 MAX.
1,909 SF (64% OF REQUIREMENT)
SUPERIOR LANDSCAPING (SEE BELOW)

SUPERIOR LANDSCAPING REQUIREMENTS

- i. PALMS MUST BE PROVIDED IN MULTIPLES (DOUBLE OR TRIPLES)
- ii. IF PALMS AND TREES ARE COMBINED, ONE ROW OF SHRUBS CAN BE PROVIDED
- iii. IF PALMS OR TREES ARE PROVIDED, SHRUBS MUST BE INCLUDED IN LAYERING HEIGHT WITH A MINIMUM OF 2 LAYERS OR TIERS
- iv. IF TREES ARE PROVIDED, DESIGN MUST INCLUDE A MINIMUM OF 2 SPECIES
- v. TREES OR PALMS MUST BE A MINIMUM OF 14' HT
- vi. LAYERED OF HEIGHT TIERED SHRUBS ARE PROVIDED IN A VARIETY WITH A MINIMUM OF 2 SPECIES.
- vii. SUSPENDED PAVEMENT SYSTEMS ARE PROVIDED FOR THE ADJACENT VEHICULAR USE AREA

SUPERIOR LANDSCAPING PROVIDED

- i. TRIPLE CHRISTMAS PALMS
- ii. THREE ROWS OF SHRUBS
- iii. THREE LAYERS
- iv. ORANGE GEIGER, LIGUSTRUM, CHRISTMAS PALM, ROYAL PALM.
- v. ROYAL PALMS ARE 22" OA. OTHER TREES UNDER BUILDING ABOVE ARE LOWER DUE TO CANOPY HEIGHT CONSTRAINTS.
- vi. PLANT MATERIAL LAYERED WITH 8 SPECIES.
- vii: N/A